

# Installation Instructions

## Flex-Lifter™ Retrofit Stop Kit

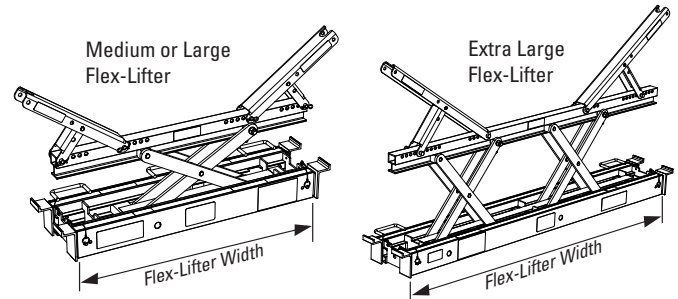
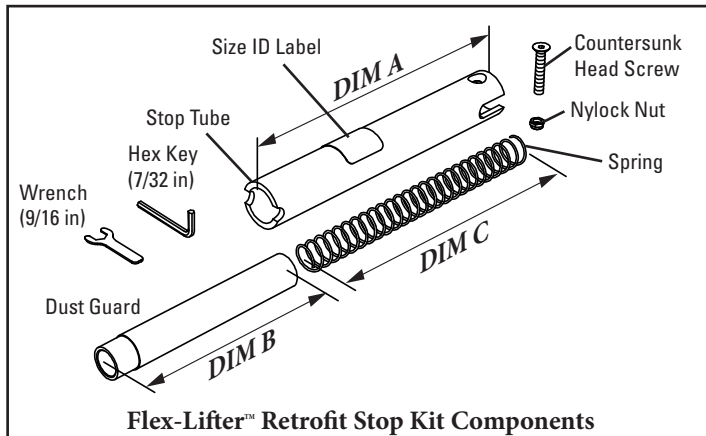

Kit Item No.	Flex-Lifter Size	Flex-Lifter Width		Dim "A"		Dim "B"		Dim "C"		Spring Color
		in.	mm	in.	mm	in.	mm	in.	mm	
90417	Medium	40	1016	13.0	330	8.8	224	11.0	279	Purple
90418	Large	50	1270	15.0	381	10.0	254	16.0	406	Silver
90419	XL	70	1778	15.5	394					

**This Retrofit is required on all Flex-Lifters within the following Serial Number series:**  
 up to **4202** (original SN label series)  
 up to **S1553** (Spanish SN label series)  
 up to **0010845** (new barcoded SN label series)

**NOTE:** Prior to starting, verify Flex-Lifter Retrofit Stop Kit matches Flex-Lifter size.

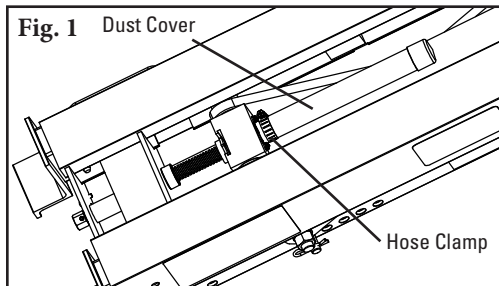

- Flex-Lifter™ must be in the fully-closed position prior to starting work.** Turn Flex-Lifter over. From the **BOTTOM** of the Flex-Lifter, use a flat head screwdriver to loosen the Hose Clamp. Remove Dust Cover Hose and Hose Clamp and discard (Fig. 1).

**NOTE:** Units purchased prior to June 2010 may have a Collar attached to the end of the threaded rod in place of the Dust Cover Hose. Use a 9/64" hex key to loosen the Collar. Remove Collar and discard.

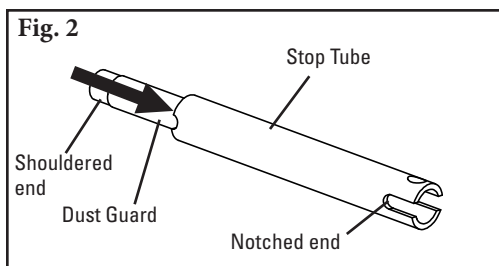

- Slide the Dust Guard into the Stop Tube.** Ensure the shouldered end of the Dust Guard is facing **AWAY** from the notched and drilled end of the Stop Tube (Fig. 2).

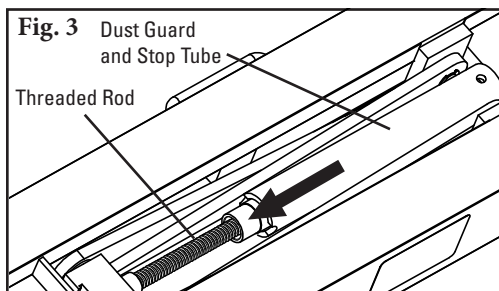

- Slide the assembled Dust Guard and Stop Tube onto the threaded rod** (Fig. 3).

4. **Insert the Spring into the Stop Tube (Fig. 4).**

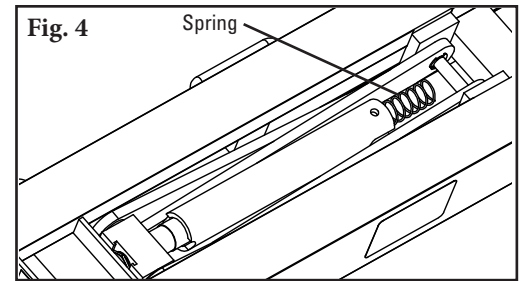

5. **Slide the notch of the Stop Tube over the Pivot Pin (Fig. 5).**  
Ensure the countersunk hole in the Stop Tube is facing away from you (toward the TOP of the Flex-Lifter) (Fig. 5)

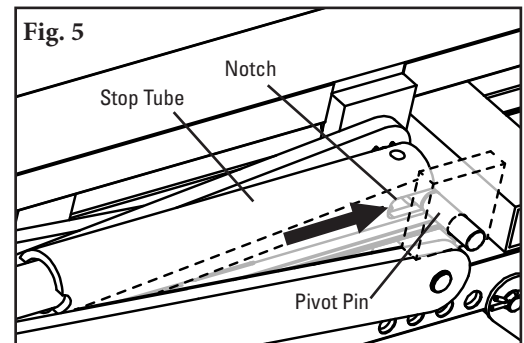

6. **Turn the Flex-Lifter upright; partially open Flex-Lifter.** From the TOP of the Flex-Lifter, insert the Countersunk Head Screw into the Stop Tube (Fig. 6).

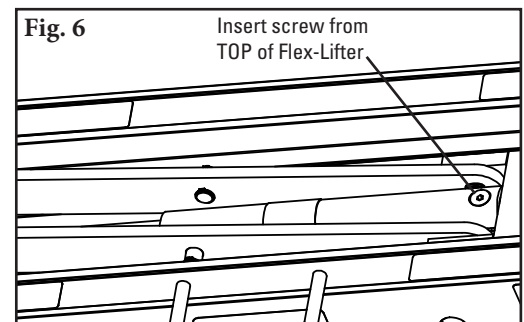

7. **Turn the Flex-Lifter on side.** Using the hex key and wrench provided, install and tighten the Nylock Nut on the Countersunk Head Screw at bottom of Stop Tube (Fig. 7) until end of screw is flush with bottom surface of nut.

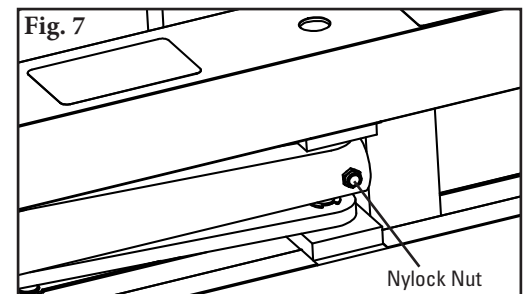

2525 Wisconsin Avenue • Downers Grove, IL 60515-4200 • USA  
Tel: (630) 971-0150 • Fax: (630) 971-1180 • E-mail: info@flexco.com

Visit [www.flexco.com](http://www.flexco.com) for other Flexco locations and products.

©2016 Flexible Steel Lacing Company. 04/16. For Reorder: X4174

