

# TRANSFER CHUTES with Tasman Warajay Technology™

## The Technology That Delivers the Control You Need

Flexco, a worldwide leader in belt conveyor solutions, has been solving transfer point challenges for more than 25 years. Using Tasman Warajay Technology™, the most powerful controlled flow technology on the market, not only will your system show improved throughput, but it will also be easy to maintain and last for decades.

**ELIMINATE** PLUGGING

**REDUCE** DUST

**DELIVER** PRECISE DIVERSION

**TAKE CONTROL**



## TRANSFER CHUTES

with Tasman Warajay Technology™

# The Difference Is Superior Technology

Over the years, bulk material handling has experimented with different approaches to improving material transfer. Some rely on funnel-and-pipe systems, dead beds, or rock boxes, which focus exclusively on containment and often become plugged. Others choose more elaborate systems that promise some measure of “flow” handling. But neither of these approaches delivers the efficiency and control of Flexco Transfer Chutes with Tasman Warajay Technology™.

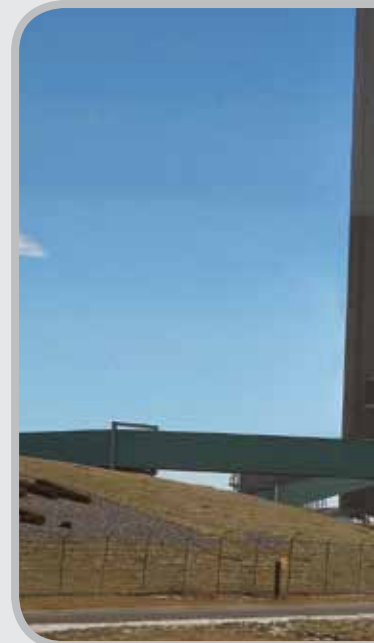

## Discover the Advantage

Moving material is always a challenge, but nowhere is it more difficult than at transfer points along your line. At these critical junctures, spillage, chute plugging, and bridging in head pulleys can cause serious problems – reductions in output, damage to your belt conveyor, safety hazards, environmental compliance issues, and more.

### *In addition, Flexco Transfer Chutes give you:*

- Substantially increased throughput
- Reductions in overall cost of ownership
- Minimization of belt wear and noise
- Reduced spillage and cleanup costs without expensive dust collectors, baffling, and skirting
- Compatibility with any conveyor orientation, including reversing conveyors and samplers



- Enhanced compliance with OSHA, NIOSH, and other regulatory standards
- Incredible durability with virtually no maintenance for decades



**We've successfully engineered solutions that include:**

- *Stackers/reclaimers*
- *Ship loader nozzles*
- *Complex diversion systems*
- *Oblique transfers*
- *Dynamic control units*
- *One-to-one in-line units*

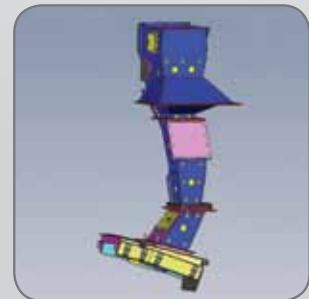
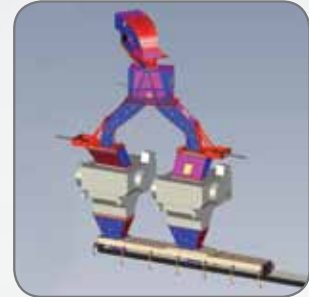

## Completely customized for your system

Using the principles of fluid dynamics, our engineers study your conveyor system to calculate your material's ideal flow path and speed. They use predictive models to optimize surface contact, angle, and velocity — which are essential to controlling plugging and spillage. Plus, we never adapt “off-the-shelf” components to your system. Tasman Warajay Technology™ solutions are completely customized to your needs.

## More productivity, fewer challenges

Because less positive air is pulled through its system, Flexco Transfer Chutes virtually eliminate dust and reduce material degradation. Only Flexco Transfer Chutes allow for the integration of our exclusive diverter bucket technology, capable of online route switching and precise load portioning. We design solutions that transfer parts of your load onto as many as five separate legs, as well as vibratory chutes and crushers.

## Quality workmanship, guaranteed performance

*Flexco specializes in assessing your transfer point needs, modeling data to accurately predict material trajectories, and designing solutions that will accommodate future fluctuations in load volume. Our success is due, in part, to our proven solution development process. It guides us through each engagement and helps ensure that you receive a solution that helps you maximize throughput and productivity.*



## TRANSFER CHUTES with Tasman Warajay Technology™

### From Simple To Complex We Deliver

From diverting material onto multiple belts to making transfers at difficult angles, every operation has special challenges and concerns. Fortunately, Flexco Transfer Chutes with Tasman Warajay Technology™ are compatible with virtually any belt conveyor system and can accommodate even the most complex requirements.

#### Step 1:

##### *Preliminary Assessment*

We assess exactly what your needs are and establish your expectations. Information you provide, including photographs of the location, all relevant drawings, and material samples, is used to determine the best possible solution(s).

#### Step 2:

##### *Proposal Submission*

Site dimensions and constraints are physically confirmed. A proposed design is developed by our engineers and submitted for review.

#### Step 3:

##### *Order Placement*

Once we've been officially engaged, we begin engineering your solution. This includes three-dimensional volume modeling, detailing, fabrication, wear-lining, protective coating, and assembly.

#### Step 4:

##### *Solution Installation*

To minimize downtime, we work with you to determine the best time and method for installing your Flexco Transfer Chute solution. This process takes anywhere from a few hours to a few days.

#### Step 5:

##### *Complete Customer Satisfaction*

We're committed to your complete satisfaction. We guarantee to meet your expectations within 90 days of the date of installation.



2525 Wisconsin Avenue • Downers Grove, IL 60515-4200 U.S.A.

Tel: (630) 971-0150 • Fax: (630) 971-1180 • E-mail: [info@flexco.com](mailto:info@flexco.com) • Web: [www.flexco.com](http://www.flexco.com)

Australia: 61-2-9680-3322 • China: 86-21-33528388 • England: 44-1274-600-942 • Germany: 49-7428-9406-0  
India: 91-44-4354-2091 • Mexico: 52-55-5674-5326 • Singapore: 65-6281-7278 • South Africa: 27-11-608-4180

©2012 Flexible Steel Lacing Company. 01-12 For Reorder: X2659

Authorized Distributor:

