

# User Instructions for Belt Cutter (100&150)



For your safety, read thoroughly the precautions and follow proper operating procedures as detailed in these instructions.



**CAUTION:** The cutter has a very sharp round blade. To avoid being cut, follow the initial setup instructions and operating instructions carefully.

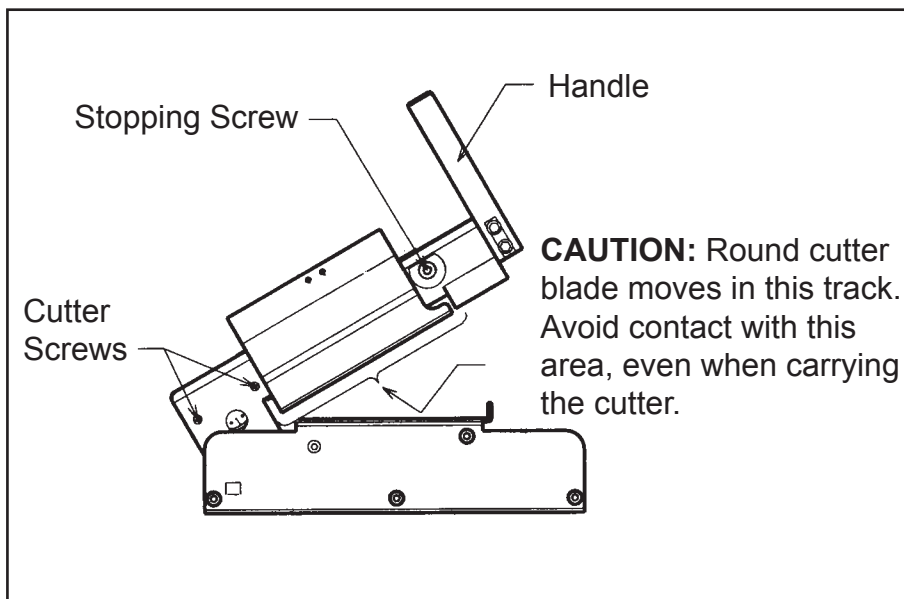
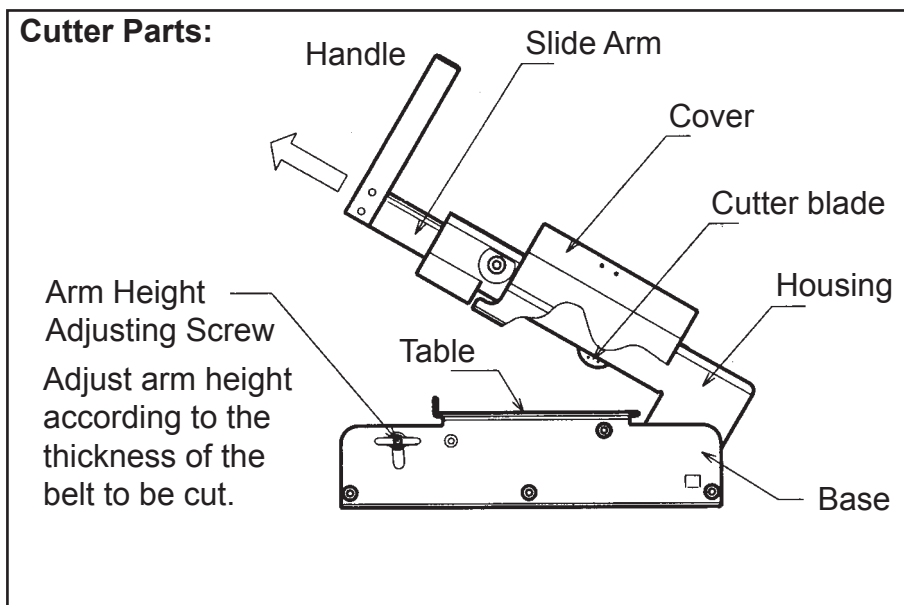

### Belt Cutting Procedures:

1. Affix belt cutter to horizontal work surface, if desired.
2. Place belt on cutter table and align in proper location for cut (Fig 1).

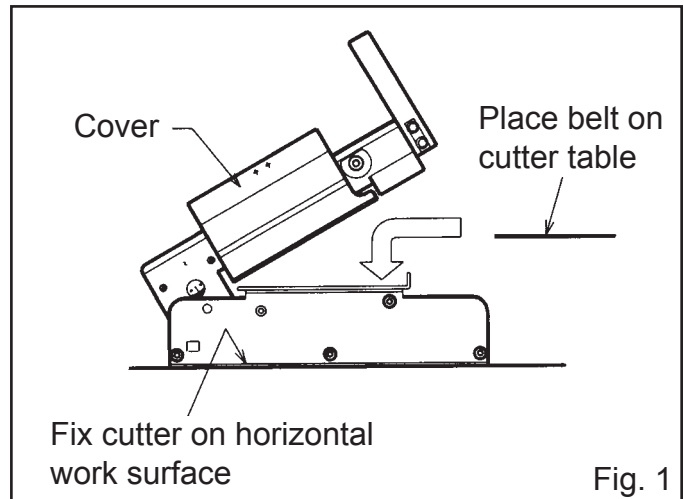

3. Apply pressure to top of cover as shown in Fig. 2.

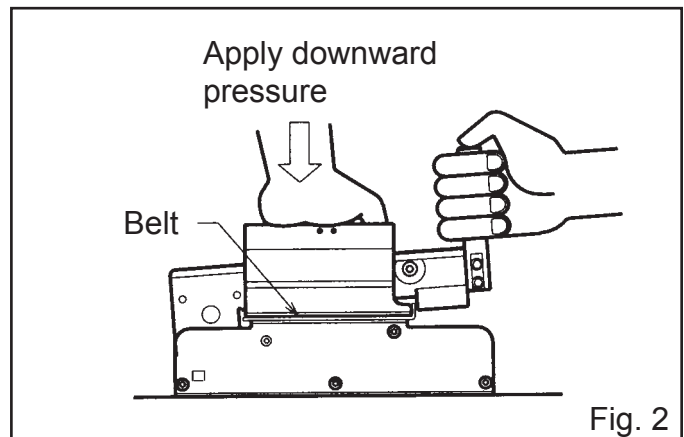

4. Continue applying pressure to cover and handle while pulling slide arm to cut belt.

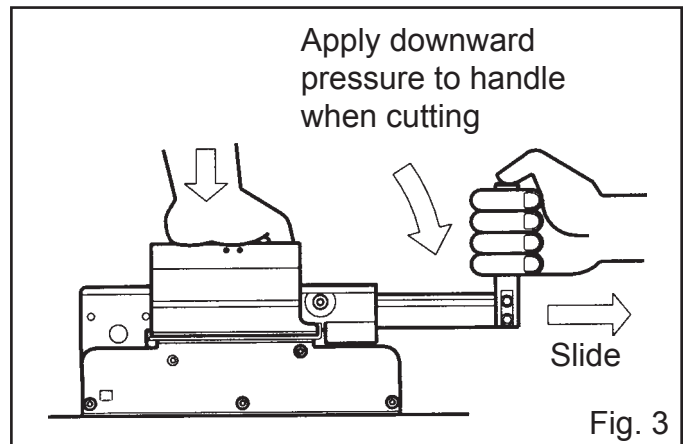

5. Push handle/slide arm back into the fully closed position and then allow the Housing to return to the 'Up' position.

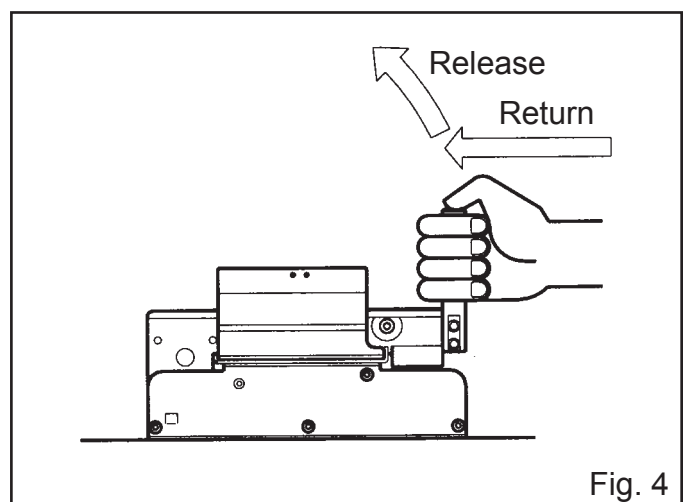

### Adjusting Blade:

Each blade has eight (8) cutting surfaces. When the blade becomes dull, rotate to next new cutting surface as follows:

1. With the Slide Arm fully retracted into the closed position, loosen the two screws through the access holes.
2. Insert a small stick into hole of cutter and turn the blade until the next cutting position is exposed (Positions will be marked 1 to 8 on cutter blade).
3. Tighten screws.

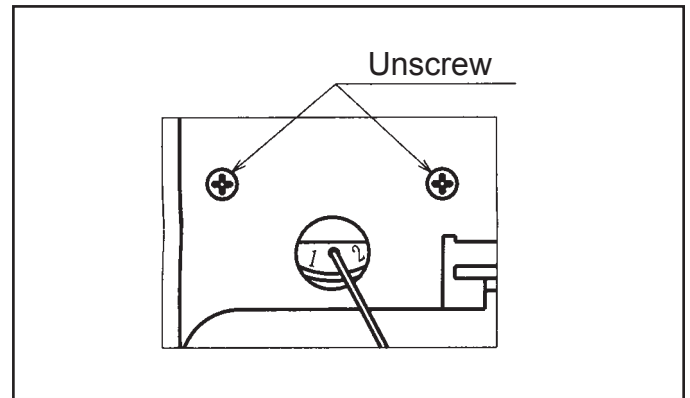

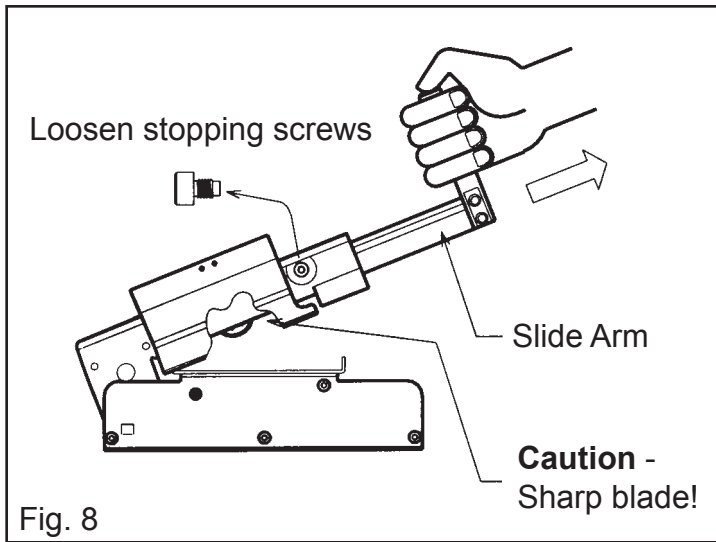

**Replacing Worn Cutter Blade:** When all 8 blade positions have been used, replace the blade with a new one.

1. Loosen stopping screws and slowly/ carefully pull the Slide Arm out of the Housing (Fig. 8). CAUTION: Sharp blade will be exposed.
2. Remove the two screws and bearing that secure the blade (Fig. 9).
3. Remove worn blade.
4. Insert new blade in slot, with the first cutting position (#1) facing down (Fig. 9).

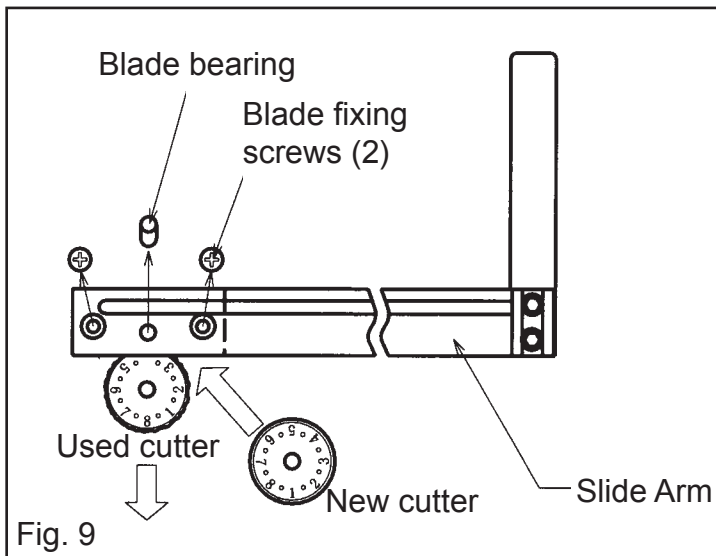

5. Press bearing in center of blade and retighten fixing screws.
6. Insert Slide Arm in Housing and tighten stopping screws (Fig. 10).

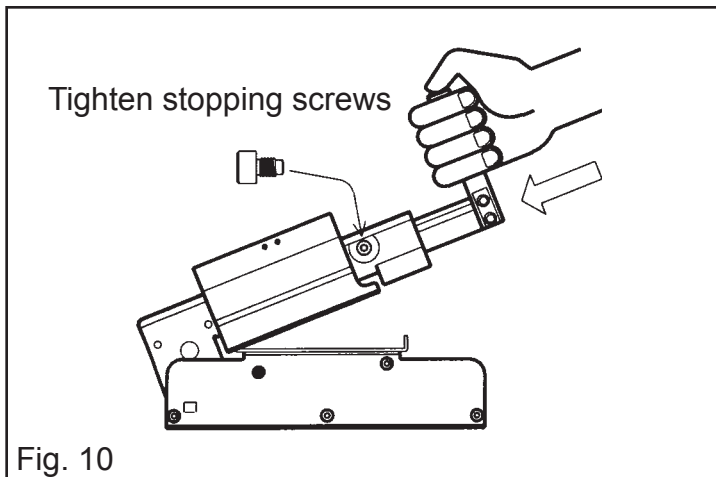

1995 Oak Industrial Dr. NE • Grand Rapids, MI 49505 U.S.A.  
 Telephone: (616)-459-3196 • Fax: (616)-459-4976 • E-mail: info@flexco.com • Web: [www.flexco.com](http://www.flexco.com)

Australia: 61-2-9680-3322 • China: 86-21-33528388 • England: 44-1274-600-942  
 Germany: 49-7428-9406-0 • Mexico: 52-55-5674-5326 • South Africa: 27-11-608-4180

©2008 Flexible Steel Lacing Company. Clipper® is a registered trademark. 08/08. For Reorder: X1514

